

## COPPER PIPE COMPRESSION FITTINGS FOR VALVES DESIGN SERIES

### Application

The te-sa compression fittings **208HT** is designed to connect copper pipes at radiator valves DESIGN series.

Made of high-quality materials, are available with nut polish chrome plated or painted white RAL9010 and black RAL9005. These fittings allow to fit the pipe at the valves installed on towel radiators with high aesthetic level and reliability in the service time.

These series of compression fittings can be used in combination with valves 1/2" and 3/4" thread connection, on the most commercially available pipe sizes.

All **te-sa** fittings are fully manufactured in Italy.



### Technical data

- Nut made of forged brass UNI-EN12165 CW617N
- Adaptor body made of machined brass UNI-EN12164 CW614N
- Retaining ring made of brass UNI-EN12164 CW614N
- Rubber preformed seal made of compound EPDM
- Nut threaded G1/2" or G3/4" for Eurocone connection
- Maximum operating temperature 90 °C
- Maximum operating pressure 10 bar
- Suitable with heating water added with glycol solutions at maximum percentage of 30%
- 3/4" size available with nut polish chrome plated
- 1/2" size Available with nut polish chrome plated or painted white RAL9010 or black RAL9005

### Dimensions

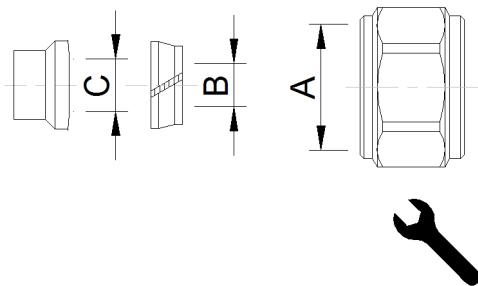

Art.	A	B	C	
208HT-04-15	1/2"	Ø15,2	Ø15	24
208HT-04-16	1/2"	Ø16,2	Ø16	24
208HT-05-12	3/4"	Ø12,2	Ø12	30
208HT-05-14	3/4"	Ø14,2	Ø14	30
208HT-05-15	3/4"	Ø15,2	Ø15	30
208HT-05-16	3/4"	Ø16,2	Ø16	30