

## STAINLESS STEEL REGULATING UNIT FOR CENTRAL HEATING SYSTEM

Coplanar distribution manifold for Art. 715N, 725N, 735N and 735NM. Available configurations: 2+1, 3+1 and 4+1 ways with flat seat nut connections 1½" Female and 1" Male on added way.

AISI 304 stainless steel body with connecting parts in chrome-plated brass alloy.

Temperature range 0÷100°C.

With EPP insulation and wall mounting brackets and screws.

Head connections 1¼" F with 140 mm centre distance.

Centre distance 125 mm.



### Technical data

#### Insulation:

Material: EPP  
Density: 45 kg/m<sup>3</sup>  
Operating temperature: -5÷120 °C  
Thermal conductivity: 0,037 W/(m·K) at 10 °C  
Reaction to fire classification (UL94): HBF

#### Manifold:

Barrels made of stainless steel 1.4301-AISI304 EN10217-7  
Swivel nuts made of brass alloy UNI-EN12165 CW617N  
Operating temperature: 0÷100 °C  
Maximum operating pressure: 8 bar  
Test pressure: 16 bar  
Flow Coefficient of the single delivery: KV=24

### Dimensions

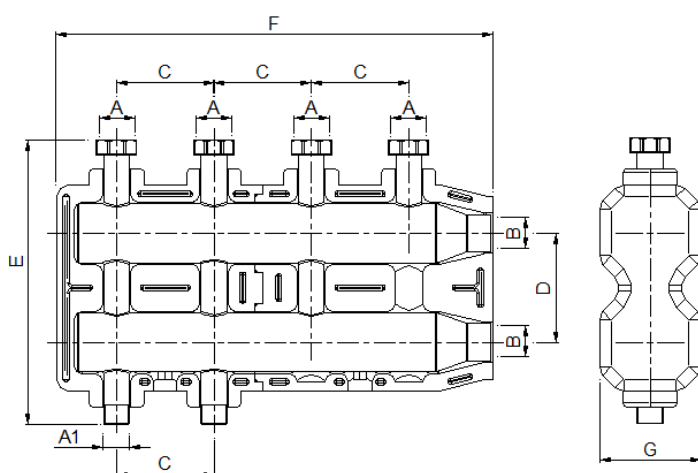

Art.	A	B	C	D	E	A1	F	G
745A-21	1½"F	1¼"F	125	140	364	1"M	560	125
745A-31	1½"F	1¼"F	125	140	364	1"M	810	125
745A-41	1½"F	1¼"F	125	140	364	1"M	1060	125

### Wall mounting sequence

