

DISTRIBUTION UNIT WITH THERMOSTATIC MIXER

Application

The distribution unit with thermostatic mixer Art. **725N** is used in heating systems where it is necessary to control the delivery temperature to the users so that it remains constantly at a predetermined value. Its greatest use is in radiant underfloor heating systems, but it is often also used in traditional radiator systems where surface temperatures of heat emitters are to be limited. Its installation can be in combination with coplanar distribution manifolds, directly combined with thermal storage tanks, or in centralized systems to be renovate.

The unit is equipped with a new-concept thermostatic mixer that combines precision adjustment with high assembly flexibility thanks to which it is possible to exchange the supply connections directly on site, without the aid of special equipment. Made of brass parts and copper tubes, it features a latest generation high efficiency circulator with high prevalence, able to adapt to the flow requirements both in terms of water rate and in terms of available pressure. The sturdy preformed insulating shell in Expanded Polypropylene limits energy losses, allows easy control and maintenance of the unit, makes it aesthetically pleasing and protected from powders.

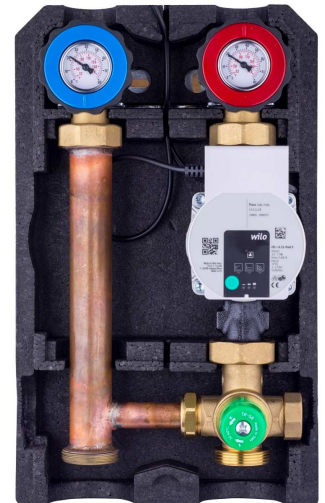

725N-086

Technical Data

- Maximum Operating Pressure 6 bar
- Maximum Test Pressure 10 bar
- Maximum Inlet Temperature at the unit 85°C
- Ball valves 1" size with control thermometers range 0÷80°C
- Lower connection 1-1/2" flat seat
- Center distance unit 125 mm
- Unit support bracket in carbon steel zinc plated
- Check-valve integrated in the return ball valve
- Setting range of the thermostatic mixer 30÷60°C
- Wax temperature sensor of the mixer with high sensibility
- Accuracy of the mixer $\pm 2^\circ\text{C}$ (with primary supply temperature at least 15°C higher than set)
- Flow coefficient of the unit $KV = 3$
- High efficiency electronic circulator Wilo Para 25/8 – 180 mm
- Automatic reset safety thermostat with threshold 55°C
- Maximum glycol percentage 30%
- Forged components made of Brass Alloy UNI-EN 12165 CW617N
- Machined components made of Brass Alloy UNI-EN 12164 CW614N
- Thermostatic mixer body with low rugosity forged
- Return pipe made of copper DN32
- O-ring made of EPDM and flat gaskets made of fiber
- Regulation knob made of ABS
- Supplying on right or on left with simple reverse of the assembly
- Totally Made in Italy

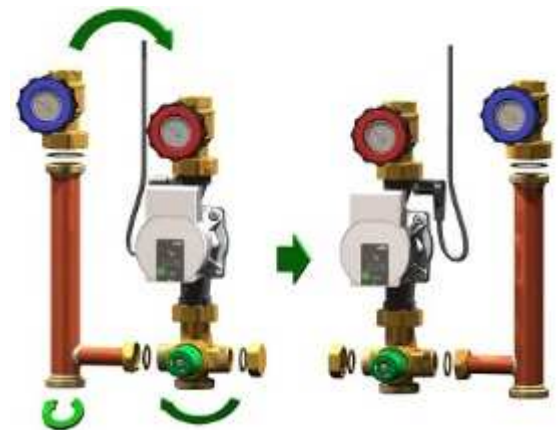

Quick and easy conversion of the unit from right delivery circulator to left delivery circulator

Dimensions

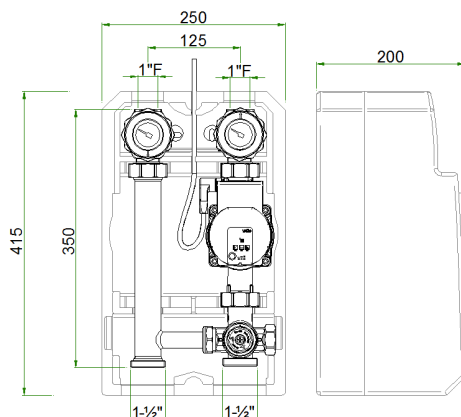

SET POS.	1	2	3	4	5	6
TEMP. °C	30	38	45	50	55	60