

AUTOMATIC AIR VENT VALVE

Application

The automatic air vent valve with chrome plated brass body **Art. 166** by **te-sa** is intended to discharge accumulated air from heating systems.

Assembled on a top position, the air vent valve automatically eliminates any air trapped in the distribution systems during their filling or during normal operations. This is an important component of hydronic systems because it allows to remove air bubbles carried in the water flow which, when accumulated in some point of the distribution pipes or manifolds, could reduce the performance of the system or generate annoying problems such as noises along the system or wear down of components. The sophisticated discharge mechanism of this air vent valve is very reliable and allows maintaining efficiency in the distribution system. The automatic air vent is also available in brass finish with **Art. 166G**.



Art. 166G

Installation

The valve is designed for vertical installation on distribution manifolds, hydraulic separators and distribution pipe lines in general. The male connection thread is equipped with O-ring seal that permits assembly without special tools.

During filling and operation of the system, the plastic cap must be slack to allow the discharge of air.

If the plastic cap is fully tightened, the air vent valve is shut off, preventing any discharge function.

Do not install in open spaces potentially subject to freezing.

In case of malfunctioning due to dirty water containing particles which would occlude the discharge orifice, the automatic air vent valve can be disassembled, washed with clean water and re-assembled. This is a delicate operation that can be done only by expert operators.

Technical data and components

- Maximum operating Pressure 10 bar
- Maximum operating Temperature 110°C
- Available with male connection thread 3/8" and 1/2"

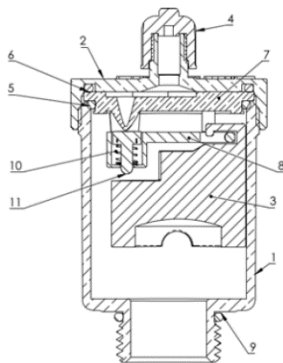

1 - Valve body	Brass UNI-EN12165 CW617N
2 - Valve cap	Brass UNI-EN12165 CW617N
3 - Float	Polypropylene (PP)
4 - Plastic cap	Polyethylene
5 - O-Ring seal	EPDM
6 - O-Ring seal	EPDM
7 - Cover disc	Acetal Resin (POM)
8 - Control lever	Acetal Resin (POM)
9 - O-Ring seal	EPDM
10 - Spring	Stainless Steel AISI 302
11 - Shutter	EPDM

Dimensions

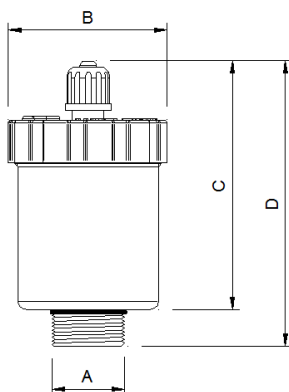

Art.	A	B	C	D
166-03	3/8"	39	63	73
166-04	1/2"	39	63	73